

**Site Location:**  
A tract of land in the W/2, E/2  
of Sec. 26, T4S, R1E containing  
7.21 acres m.o.l.

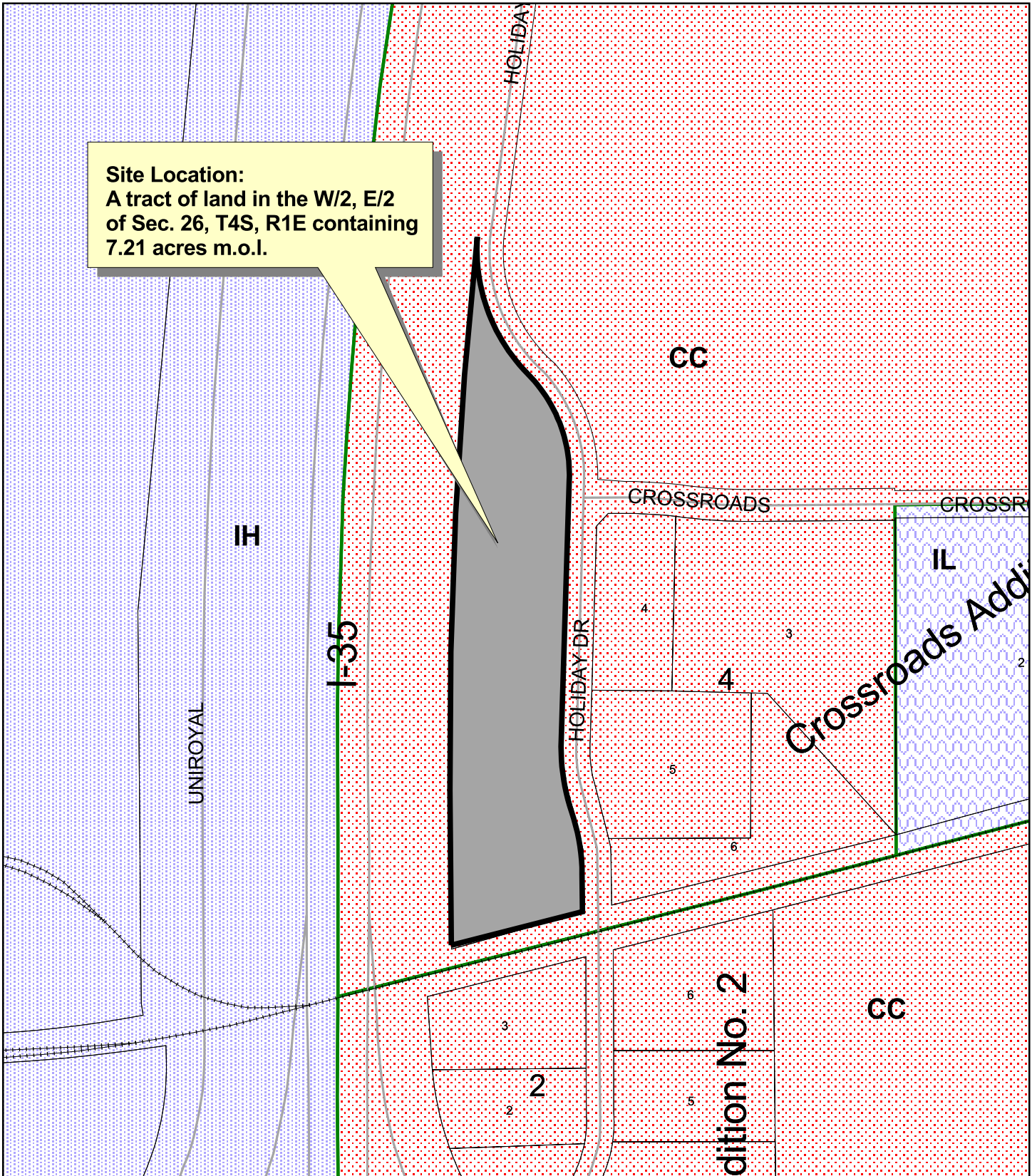

### Case # PP03-21

For a preliminary plat of 7.21 acres into 5 lots located  
West of Holiday Dr., just North of the RR tracks.



G.I.S. Department  
City of Ardmore

0 150 300 450 600 Feet



1" = 300'

Mapbook Page : E14

Copyright 2003, City of Ardmore

August 8, 2003