

Site Location:

**The W 175 ' of the W/2, NW, NW,
NW of Sec. 25, T4S, R1E
containing 2.5 acres m.o.l.**

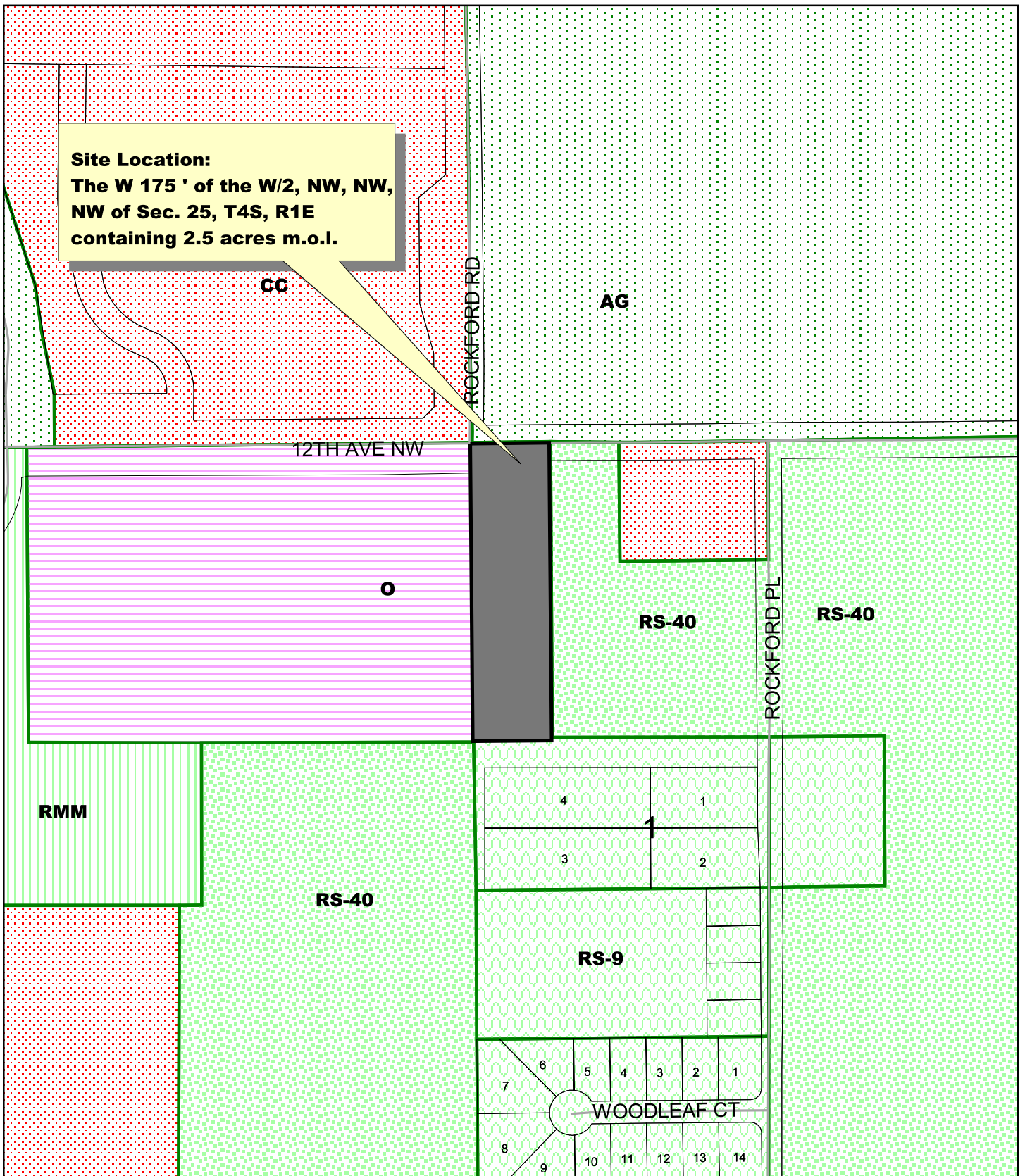

Case # PP03-19

**For a preliminary plat of 2.5 acres into 2 lots located
in the Southeast corner of 12th NW at Rockford Rd.**

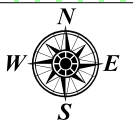

G.I.S. Department
City of Ardmore



August 8, 2003

0 150 300 450 600 Feet



1" = 300'

Mapbook Page : F14

Copyright 2003, City of Ardmore